

# AI + BetaFlight

2-in-1 Flight Controller

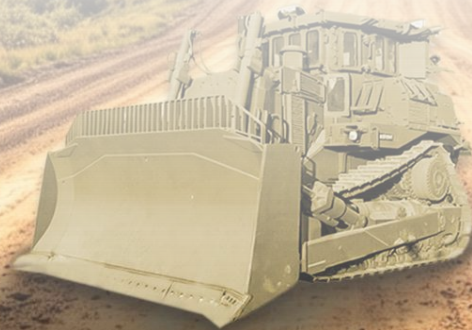



**2-in-1 design, no need to purchase a separate flight controller**



**Plug & Play · Seamless Replacement for Standard FCs**



**Easy to use, requires no additional training**



**Integrated AI Vision, Enables autonomous locking, and tracking.**



**Full compatibility with all common (CVBS) analog VTX**



**Highly Integrated & Lightweight Design**



**Exceptional Cost-Effectiveness**



# *Intelligent AI takeover, fearless in signal blind spots.*

*Advanced flight control integrated with AI enables seamless human-AI collaboration. When anticipating entry into a signal blind spot, the pilot can smoothly switch to AI takeover mode. Even with a complete loss of remote control and video transmission, the powerful onboard AI can still precisely approach the target, ensuring the mission is accomplished.*

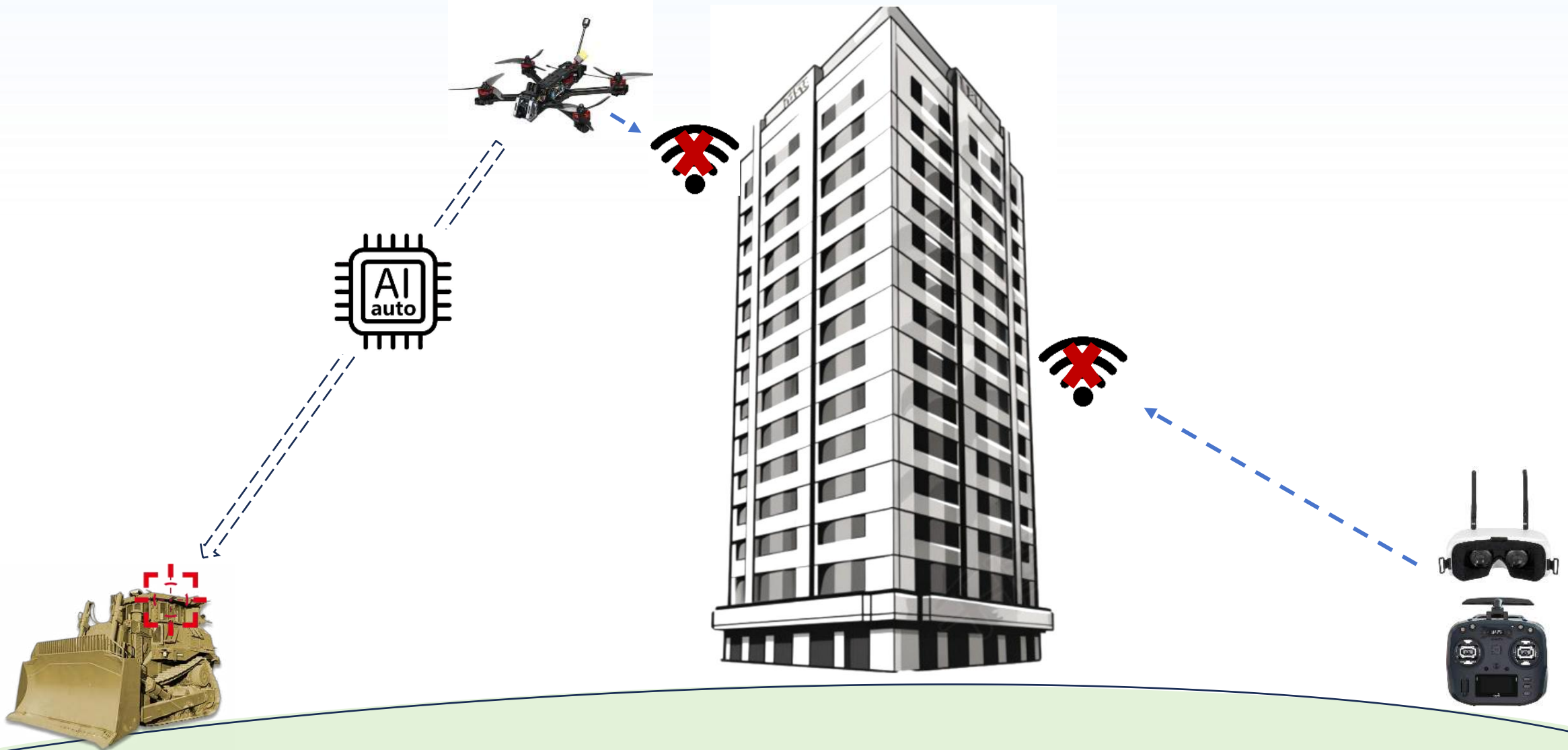



# Main Parameters

Category	Parameter	Value
<b>Core Specs</b>	Supported Frames	5-18 inch quadcopters
	Firmware	<b>Beta Flight (No extra purchase. )</b>
	Input Voltage	4S - 8S LiPo
	Power Consumption	2W
	Weight	10 g
<b>Camera &amp; Vision</b>	Camera Compatibility	1080P Digital Camera
	Lens Focal Length	4mm
	Frame rate	60FPS
	Camera Angle	0-60° ( 20-30° Recommended )
	Field of View (FOV)	96°
	Video Output Format	CVBS
	Starlight Night Vision	Available
	AI Performance	AI Lock Range
	Minimum Target Size	20x20 pixels
	Max Target Speed	> 80km/h
	AI Lock Modes	<b>Hard Lock : Crosshair mandatory lock, Capable of locking onto any kind of targets, moving &amp; stationary.</b>
<b>Peripherals&amp; Connectivity</b>	Receiver Protocol	ELRS(CRSF)
	ESC Protocol	DSHOT 300/600
	Servo	Two-channel PWM servo signal
<b>Environmental</b>	Operating Temperature	-25°C to 55°C

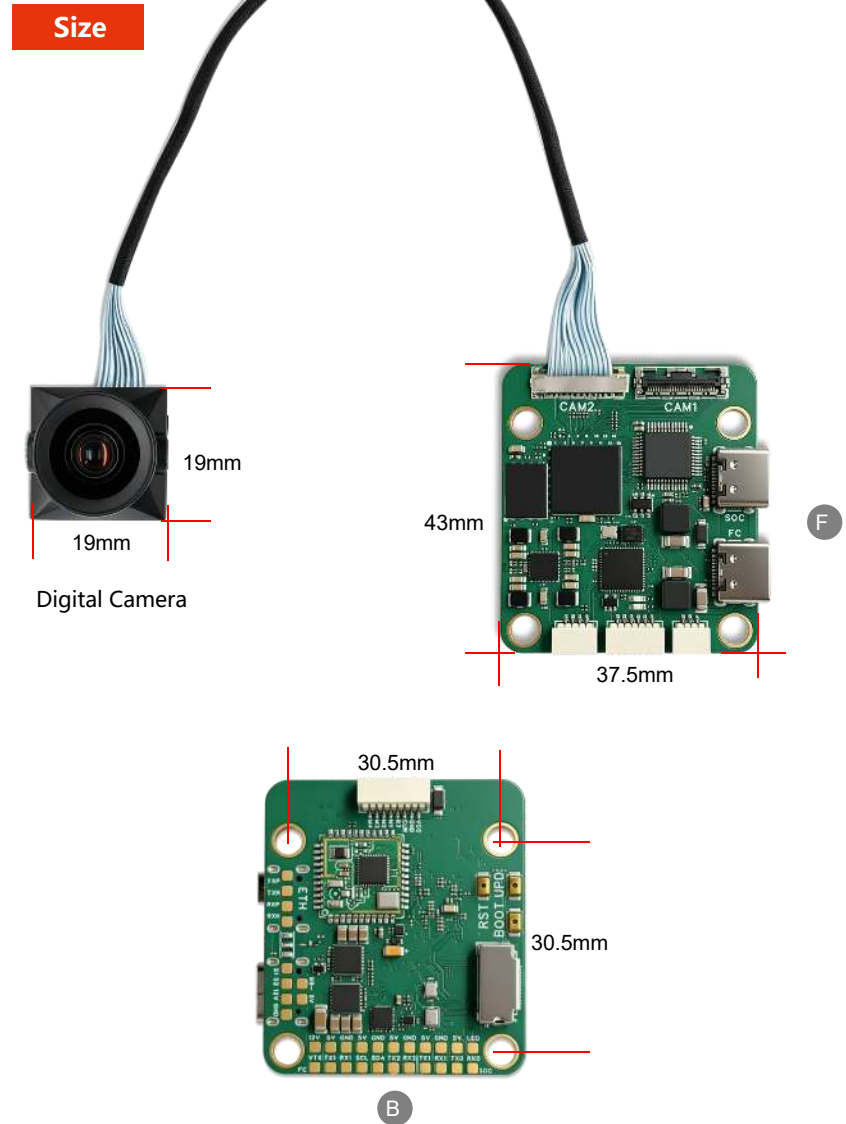

 **Main Feature - Universal mandatory (any kind of targets, moving & Stationary.)**





## Main Feature - Dynamic Target Lock & Tracking Strike

